

A glass of thick, white milkshake with a slice of pineapple on the rim and a yellow straw. The background is a textured blue surface. A piece of torn paper is at the top center with the brand name. A red circle at the bottom right contains a call to action.

frischli

Shake
it like
that!

Create
delicious
milkshakes
easily and
quickly!

Mhhh, Milkshakes!

Milkshakes are not only a delicious treat in the summer, but they are also quick to make! They combine creamy ice cream with milk and exciting ingredients such as fruit, nuts, sweet toppings and more. Perfect as a dessert on the spot or on the go. Simply deeeelicious!

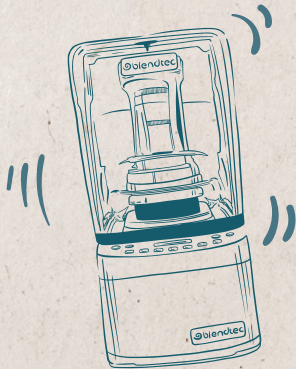

Milkshakes
make more
turnover!





Content

- p. 4** Milkshake Strawberry
- p. 6** Milkshake Piña Colada
- p. 8** Milkshake Peanut
- p. 10** Milkshake Caramel
- p. 12** Milkshake Espresso
- p. 14** Milkshake Cookie Crunch



Milkshake

Strawberry



Lemon juice
1 tsp

+



Fresh
strawberries
100 g

+



Crushed Ice
200 g



200 g

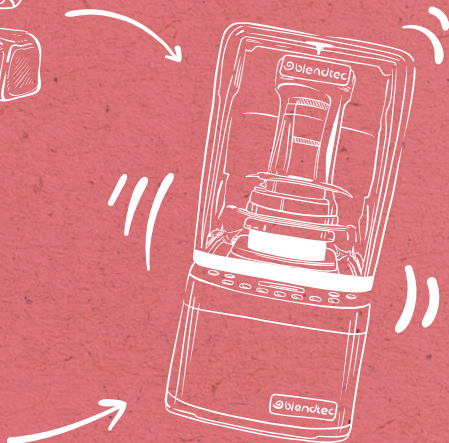

15 sec

6

Speed
setting

Decorate with strawberries



Milkshake

Piña Colada



Coconut milk
100g



Pineapple pieces
100g



100g



Crushed Ice
200g

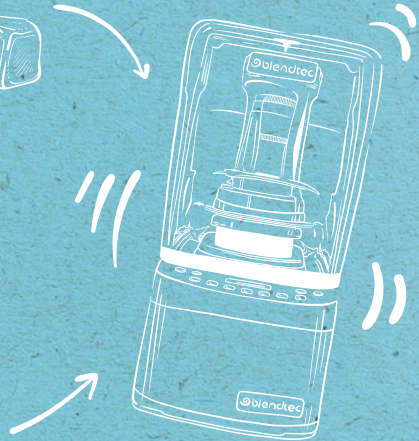

15 sec



Speed
setting

Decorate with
pineapple pieces



Milkshake

Peanut



Crushed Ice
300g



Creamy
peanut butter
100g



200g

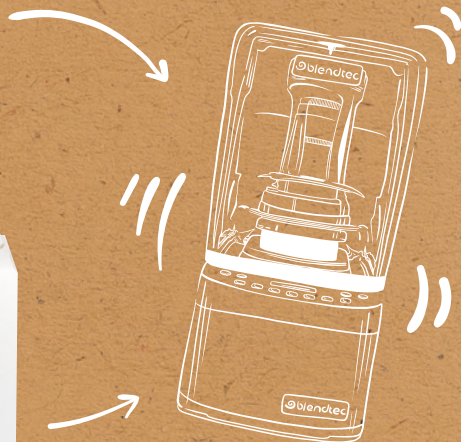

15 sec



Speed
setting

Decorate with
cream and coarse
sea salt



Milkshake

Caramel



Crushed Ice
200g



200g

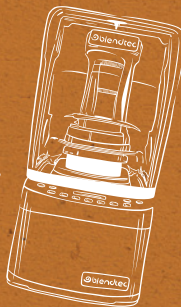

Caramel sauce
e. g. Lotus Biscoff
biscuit

75g



15 sec

6

Speed
setting

After mixing:

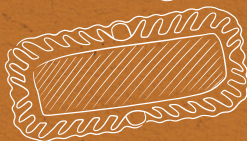

Add
biscuits,
such as
Lotus
Biscoff
20 g



5 sec

1

Speed
setting

Decorate
with cream, caramel
sauce & biscuits



Milkshake Espresso



Crushed Ice
200g



200g



15 sec

6

Speed
setting



Espresso
100g

Decorate
with cream &
coffee beans



Milkshake

Cookie Crunch



Crushed Ice
150g



250g

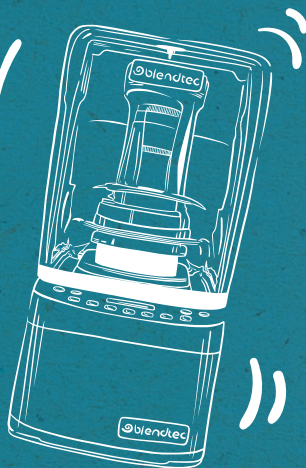

15 sec

6
Speed
setting

After mixing:



Add
crunches,
such as Oreo
cookies
20 g

5 sec

1
Speed
setting

Decorate with
cream & crunches



The logo for Frischli, featuring the word "frischli" in a red, cursive font with blue accents above the 'i' and 'l'. A blue horizontal line is positioned below the text.

frischli

FRISCHLI MILCHWERKE GMBH

Bahndamm 4 · 31547 Rehburg-Loccum · Germany

Phone: +49 5037-301-0 · Fax: +49 5037-301-120

foodservice-eu@frischli.de · www.frischli-foodservice.de/en